

# THERMAL Deburring

ATL Anlagentechnik Luhden GmbH - Machines for thermal deburring

## Data Sheet

### *iTEMPlastics*

Dimensions	
Length	2,600 mm
Width	1,610 mm
Height	2,600 mm
Weight	4,000 kg
Max. component size	
Cylindric components	
Quadratic components	400 x 400 x 800 mm
Electric power supply	
Power requirement	approx. 20 kVA
Line voltage	400 V/N/PE ~ 50 Hz
Deburring chamber	
Volume	420 x 420 x 800 mm
Max. gas inflated pressure 2 bar absolute	

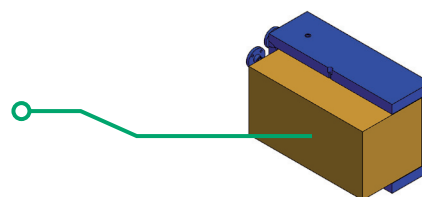

### Standard Equipment

- Control system: SIEMENS PLC with touch-screen
- Cycle times: 60 - 120 seconds
- Operating gas: Oxygen and hydrogen
- Safety arrangement: TÜV certified, ATEX, CE marking, gas monitoring system

### Applicable Plastics

- PMMA (polymethylmethacrylate), acryl glass, POM (polyoxymethylene), PA (polyamide), PA casting, PUR (Polyurethane), ABS (acrylnitrile-butadiene-styrene), PE (polyethylene), PP (polypropylene), silicone, laser sinter substances, NBR, Viton

### Plastics applicable to a limited degree

- PEEK (polyetheretherketone), PVDF, natural latex

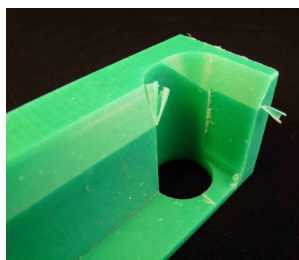
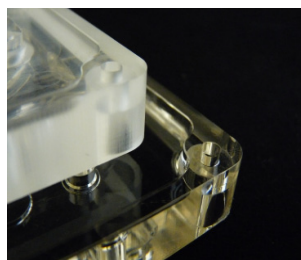

# THERMAL Deburring

ATL Anlagentechnik Luhden GmbH - Machines for thermal deburring

## Datenblatt Product Overview

	<i>iTEM250 SC</i>	<i>TEM320 SC</i>	<i>iTEM400</i>	<i>iTEM400/600</i>	<i>iTEMPlastics</i>
<b>Dimensions</b>					
Length	3,100 mm	3,100 mm	3,800 mm	3,800 mm	2,600 mm
Width	1,800 mm	1,800 mm	1,800 mm	1,800 mm	1,610 mm
Overall width	2,400 mm	2,400 mm	2,500 mm	2,500 mm	1,610 mm
Height	2,600 mm	2,600 mm	2,600 mm	2,850 mm	2,600 mm
Working height	1,100 mm	1,100 mm	990 mm	1,380 mm	810 mm
Weight	10,000 kg	10,000 kg	15,000 kg	17,000 kg	4,000 kg
<b>Max. component size</b>					
Cylindric components	Ø 240 x H 280 mm	Ø 310 x H 280 mm	Ø 395 x H 280 mm	Ø 395 x H 580 mm	
Quadratic components	170 x 170 x 280 mm	220 x 220 x 280 mm	275 x 275 x 280 mm	275 x 275 x 580 mm	400 x 400 x 800 mm
<b>Electric power supply</b>					
Power requirement	approx. 30 kVA	approx. 30 kVA	approx. 30 kVA	approx. 30 kVA	approx. 20 kVA
Line voltage	400 V/N/PE ~ 50 Hz				
Control voltage	24 V DC				
<b>Operating media</b>					
Medium 1	methane*	methane*	methane*	methane*	hydrogen
Medium 2	oxygen	oxygen	oxygen	oxygen	oxygen

\* Hydrogen and natural gas are also applicable. Natural gas may not contain more than 2% of inert gas and in addition, a natural gas compressor is needed.

